

# Welcome!

## Ridgeland Common Master Plan

Public Meeting Number Four

June 7, 2008

Ridgeland Common  
Park District of Oak Park

\*In partnership with the community, we provide quality parks  
and recreation experiences for the residents of Oak Park.\*

#Bonestroo



# Park District of Oak Park Ridgeland Common Master Plan

Public Meeting Number Four  
Agenda

Gary Balling – Executive Director PDOP

- Introductions and Overview

Jim Maland – Bonestroo Team Project Manager

- Meeting Expectations
- Overview of Process to Date
- Master Plan Options
- Tree Preservation Plans
- Operational Costs
- Capital Costs
- Next Steps
- Formal Public Input Session (3 minute open mike)

Ridgeland Common  
Park District of Oak Park

\*In partnership with the community, we provide quality parks  
and recreation experiences for the residents of Oak Park.\*

# Meeting Expectations

- Time Commitment – 1½ to 2 Hours
- Understanding of Master Plan Options
- Understanding of Some Impacts
  - Trees
  - Operations
  - Capital Investment
- Receive YOUR Input

# Ridgeland Common's Goal

- Revenue Generating
- Multi-purposed
- Community Centered
- Partnership Oriented

Ridgeland Common  
Park District of Oak Park

\*In partnership with the community, we provide quality parks and recreation experiences for the residents of Oak Park.\*

#Bonestroo



# Overview of Process to Date

- Project Initiation – Mid November 2007
- Market Analysis
- Partnerships
- Space Program
- Conceptual Plans
  - Three programs
  - Two site configurations
- Conceptual Plan Hybrids
- Construction Information
- Operational Evaluation

# Overview of Process to Date

At our April 12 public meeting we said.....

- Gather Feedback on Master Plan Options
- Park Board to Narrow Options to One Existing, One Expanding and One Visionary Plan
- Develop Capital and Operating Costs for the Three Plans
- Public Meeting in June to Obtain Input on the Three Refined Options and Costs

# Project Site

Public Parking Ramp

Church

Apartments

810 feet

OPRF High School  
Athletic Fields

360 feet

Existing, Expanding and Visionary Plans  
6.1 + Acres

300 feet





Elevated Railroad



0 50' 100' 150'

Ridgeland Common  
Park District of Oak Park

**LEGEND**

-  FENCING
-  40' HIGH NETTING
-  PROPOSED TREES
-  EXISTING TREES

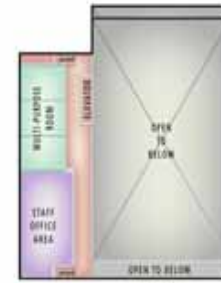

SECOND FLOOR



**EXISTING PLAN**  
JUNE 2008

Ridgeland Common  
Park District of Oak Park

"In partnership with the community, we provide quality parks and recreation experiences for the residents of Oak Park."







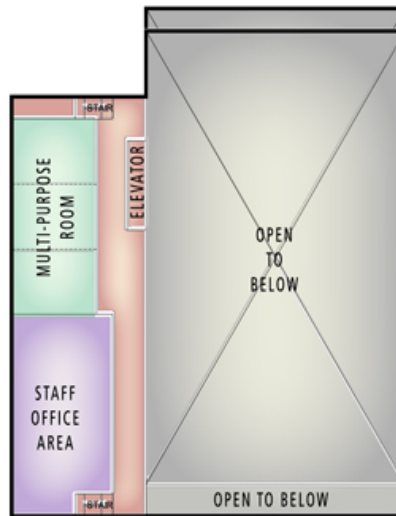

Ground Floor Level



SECOND FLOOR

**LEGEND**

-  FENCING
-  40' HIGH NETTING
-  PROPOSED TREES
-  EXISTING TREES

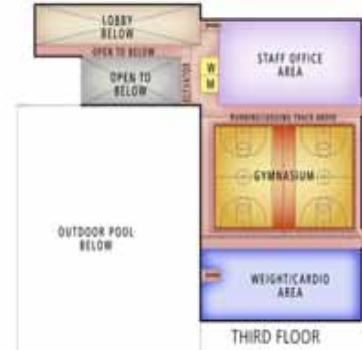
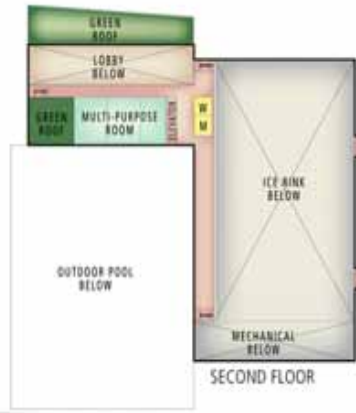

**EXPANDING PLAN**  
JUNE 2008

Ridgeland Common  
Park District of Oak Park

"In partnership with the community, we provide quality parks and recreation experiences for the residents of Oak Park."





Ground Floor Level

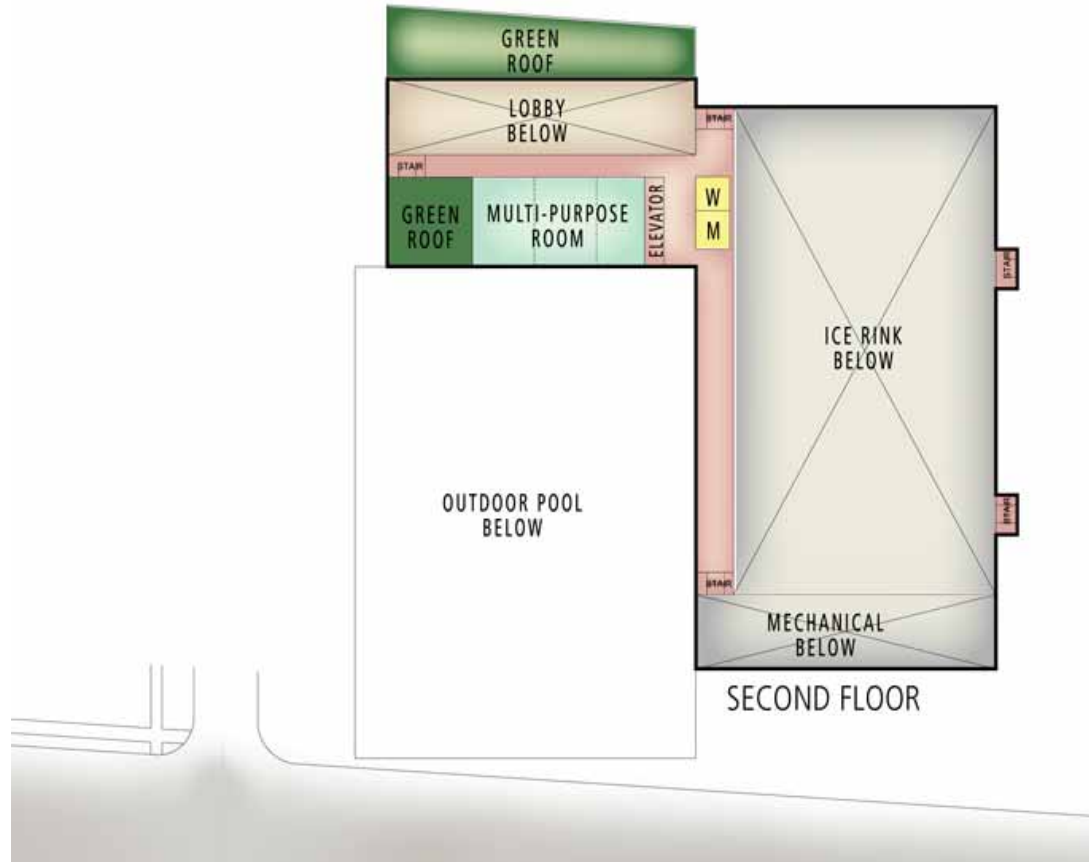

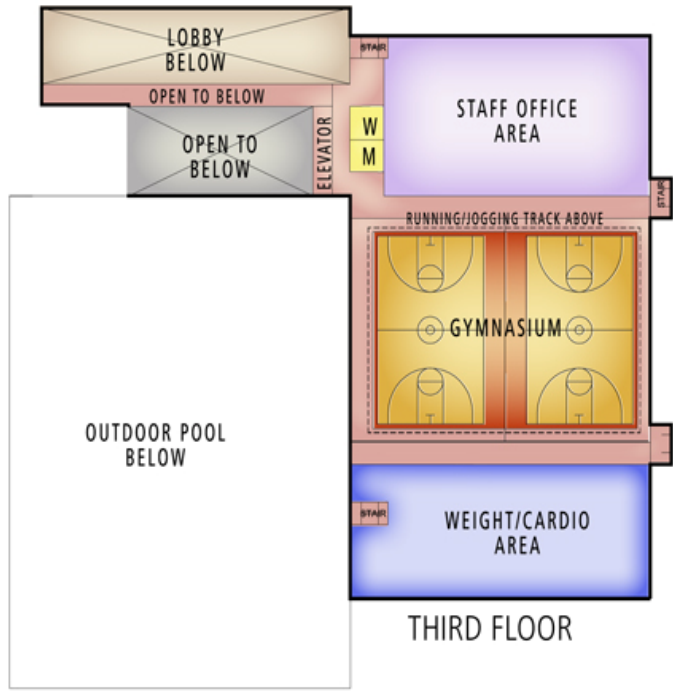

THIRD FLOOR

Ridgeland Common  
 Park District of Oak Park

"In partnership with the community, we provide quality parks and recreation experiences for the residents of Oak Park."



**LEGEND**

- FENCING
- 40' HIGH NETTING
- PROPOSED TREES
- EXISTING TREES



LOWER LEVEL FLOOR

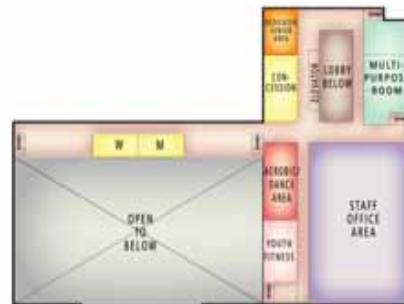

SECOND FLOOR

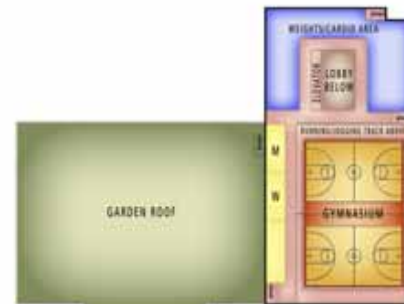

THIRD FLOOR



**VISIONARY PLAN**  
JUNE 2008

Ridgeland Common  
Park District of Oak Park

"In partnership with the community, we provide quality parks and recreation experiences for the residents of Oak Park."





Ground Floor Level

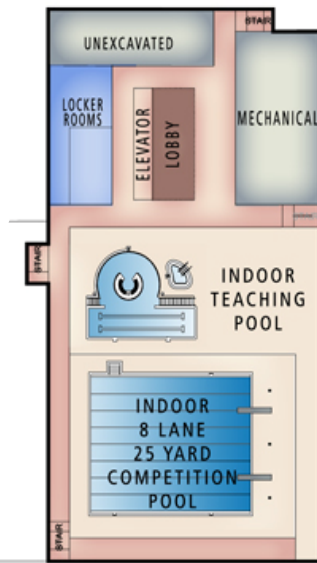

LOWER LEVEL FLOOR

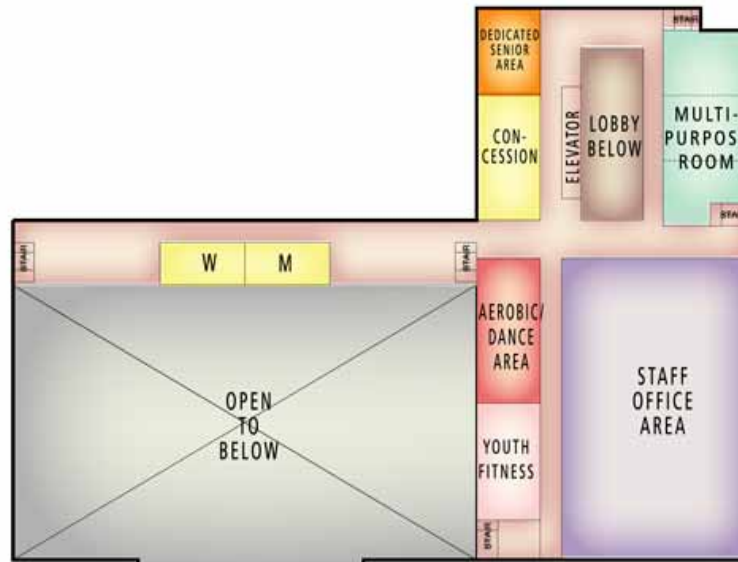

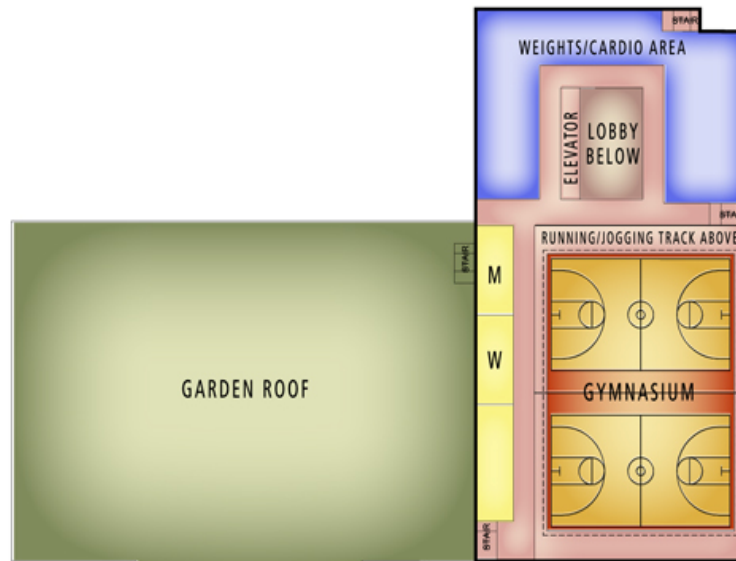

SECOND FLOOR



THIRD FLOOR

# TREE PRESERVATION PLAN

## LEGEND

-  TREE TO BE PRESERVED (57 TREES)
-  TREE TO BE REMOVED (67 TREES)

CALIPER INCHES TO BE REMOVED: 727"  
 PROPOSED CALIPER INCHES: 126"  
 (42 TREES)



EXISTING PLAN  
 JUNE 2008



Ridgeland Common  
 Park District of Oak Park

"In partnership with the community, we provide quality parks and recreation experiences for the residents of Oak Park."



# TREE PRESERVATION PLAN

## LEGEND

-  TREE TO BE PRESERVED (70 TREES)
-  TREE TO BE REMOVED (54 TREES)

CALIPER INCHES TO BE REMOVED: 695"

PROPOSED CALIPER INCHES: 117"  
(39 TREES)

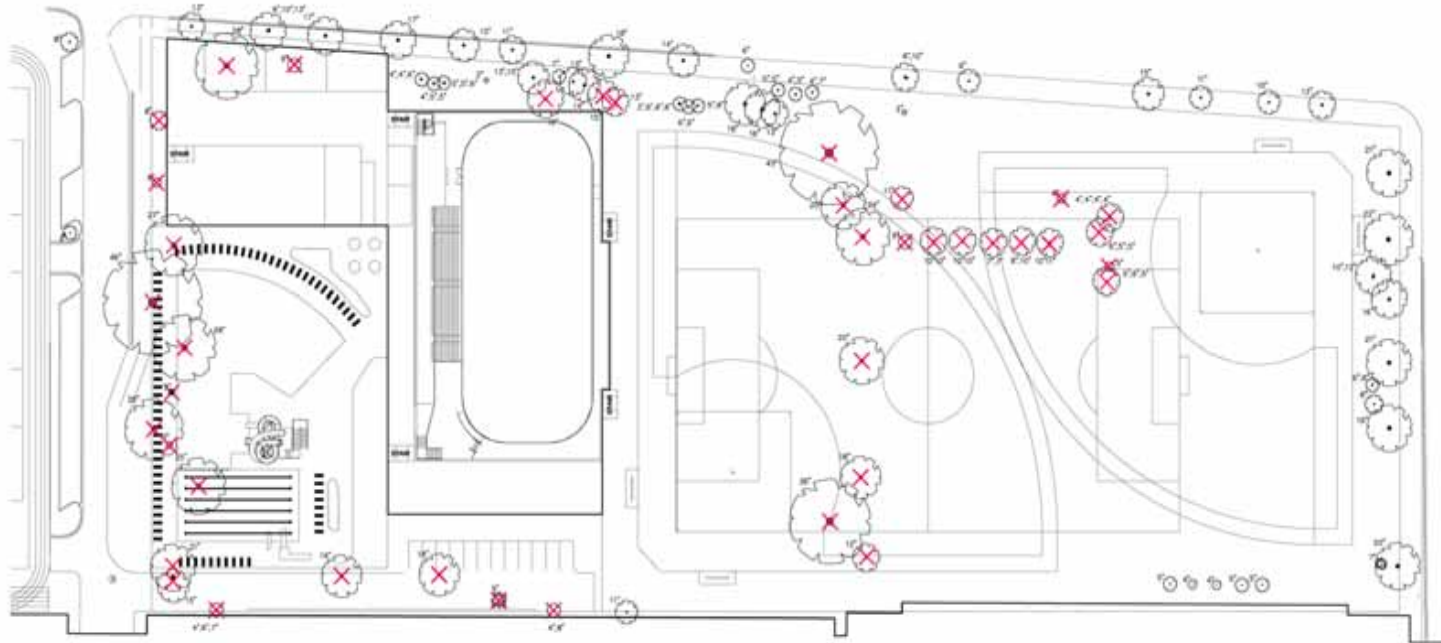

EXPANDING PLAN  
JUNE 2008

Ridgeland Common  
Park District of Oak Park

"In partnership with the community, we provide quality parks and recreation experiences for the residents of Oak Park."

Bonestroo



# TREE PRESERVATION PLAN

## LEGEND

-  TREE TO BE PRESERVED (45 TREES)
  -  TREE TO BE REMOVED (79 TREES)
- CALIPER INCHES TO BE REMOVED: 936"
- PROPOSED CALIPER INCHES: 195"  
(65 TREES)



VISIONARY PLAN  
JUNE 2008

Ridgeland Common  
Park District of Oak Park

"In partnership with the community, we provide quality parks and recreation experiences for the residents of Oak Park."



# Existing Facility

## Revenue/Expenditure Comparison

Category	8-Month Ice	12-Month Ice
Total Expense	\$1,411,171	\$1,431,819
Revenues	\$1,586,020	\$1,587,480
Difference	\$174,849	\$155,661
Recovery Percentage	112%	111%

# Expanded Facility

## Revenue/Expenditure Comparison

Category	8-Month Ice	12-Month Ice
Total Expense	\$2,162,011	\$2,171,666
Revenues	\$1,917,273	\$1,935,618
Difference	(\$244,738)	(\$236,048)
Recovery Percentage	89%	89%

# Visionary Facility

## Revenue/Expenditure Comparison

Category	Budget
Total Expenditures	\$3,430,489
Revenues	\$2,810,228
Difference	(\$620,261)
Recovery Percentage	82%

# Capital Cost Summary

<i>Item</i>	<i>Existing</i>	<i>Expanding</i>	<i>Visionary</i>
Building	\$13,848,000	\$29,330,000	\$47,056,000
Site	\$14,460,000	\$16,062,000	\$25,752,000
Total Construction	\$28,308,000	\$45,392,000	\$72,808,000
Escalation to June 2011	\$5,324,000	\$8,625,000	\$13,833,000
Non-Construction Costs	\$5,002,000	\$8,102,000	\$12,996,000
Total Project Cost	\$38,634,000	\$62,119,000	\$99,637,000

# Next Steps

- Complete the Work Tasks
  - Look at phasing options
  - Further develop partnership understandings
  - Financing options
  - Complete written report
  - Present final report to Board
- July 17<sup>th</sup> Report Accepted by Board for Consideration

# “Open Mic”

## Questions and Comments

3 Minutes per Speaker

Ridgeland Common  
Park District of Oak Park

\*In partnership with the community, we provide quality parks and recreation experiences for the residents of Oak Park.\*

#Bonestroo



# Thank You for Coming!

Ridgeland Common  
Park District of Oak Park

\*In partnership with the community, we provide quality parks and recreation experiences for the residents of Oak Park.\*

#Bonestroo

