

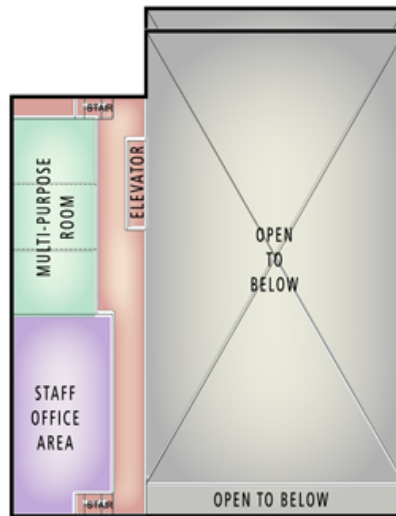



Ground Floor Level



SECOND FLOOR

**LEGEND**

-  FENCING
-  40' HIGH NETTING
-  PROPOSED TREES
-  EXISTING TREES

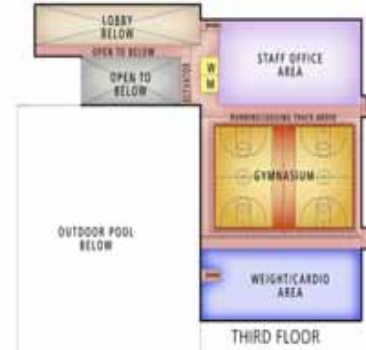
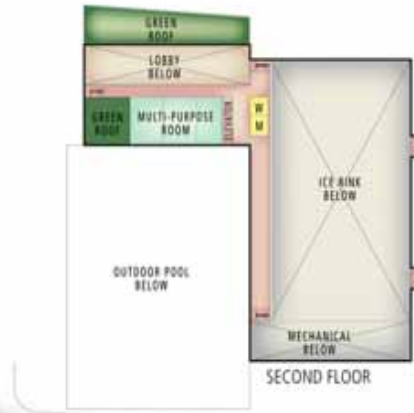

**EXPANDING PLAN**  
JUNE 2008

Ridgeland Common  
Park District of Oak Park

"In partnership with the community, we provide quality parks and recreation experiences for the residents of Oak Park."





Ground Floor Level

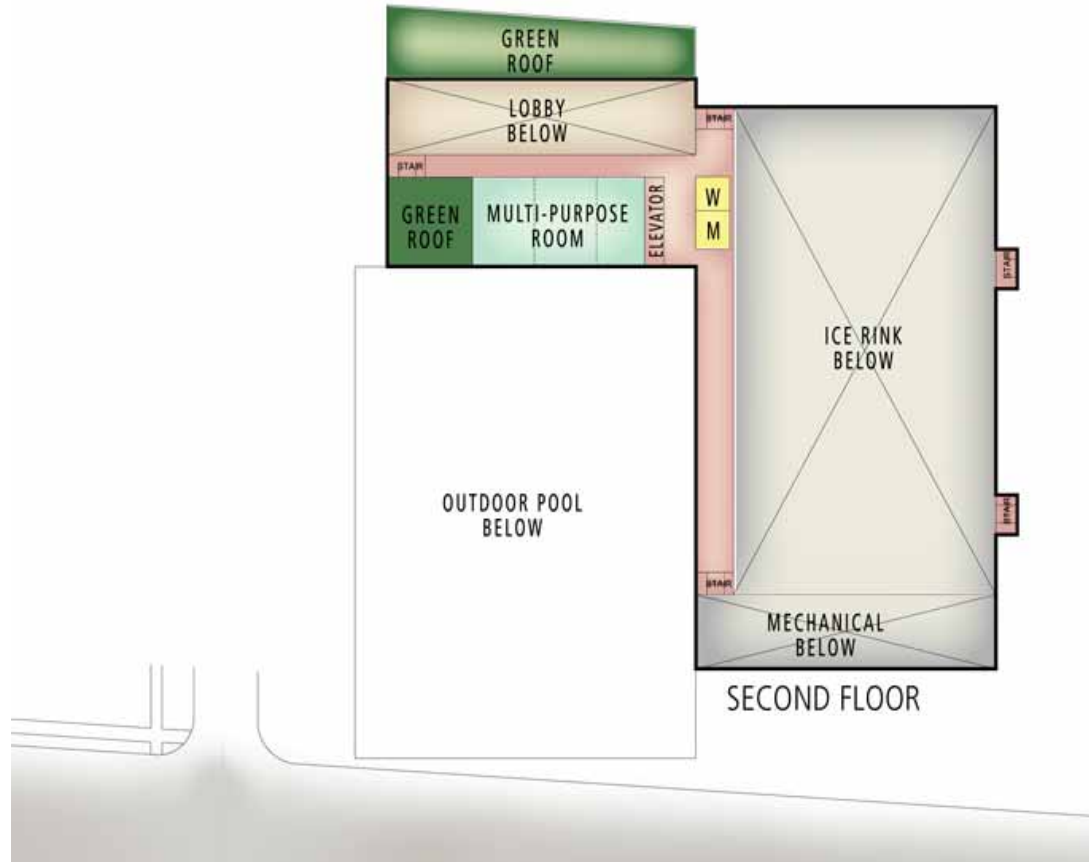

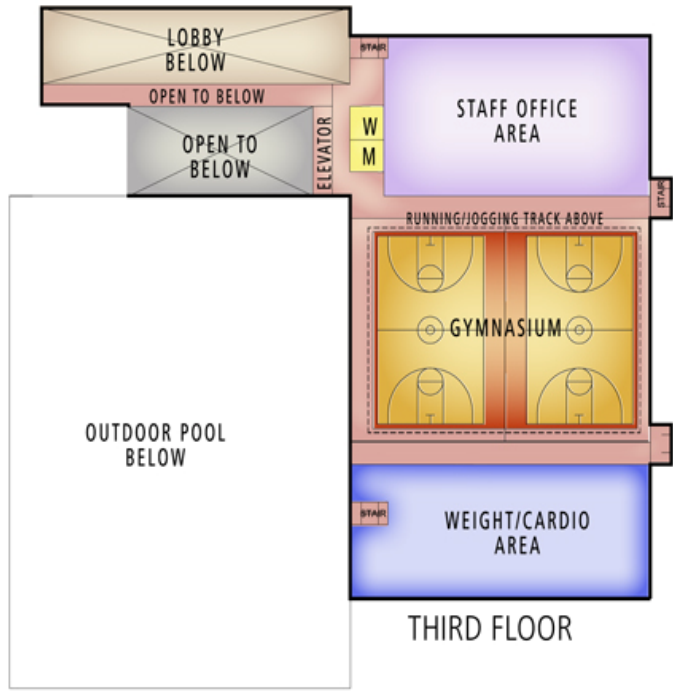

THIRD FLOOR

**LEGEND**

- FENCING
- 40' HIGH NETTING
- PROPOSED TREES
- EXISTING TREES



LOWER LEVEL FLOOR

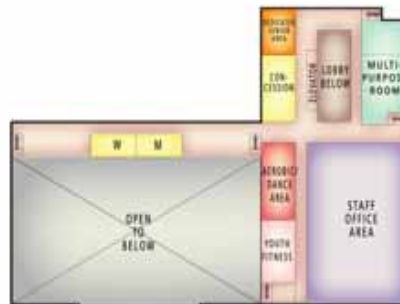

SECOND FLOOR

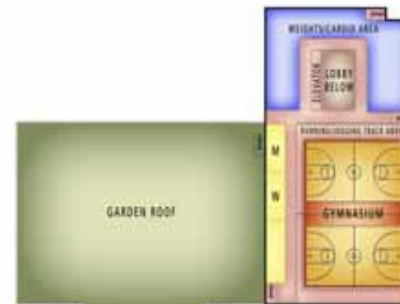

THIRD FLOOR



**VISIONARY PLAN**  
JUNE 2008

Ridgeland Common  
Park District of Oak Park

"In partnership with the community, we provide quality parks and recreation experiences for the residents of Oak Park."





Ground Floor Level

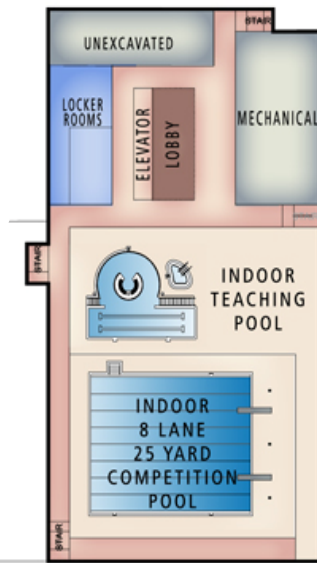

LOWER LEVEL FLOOR

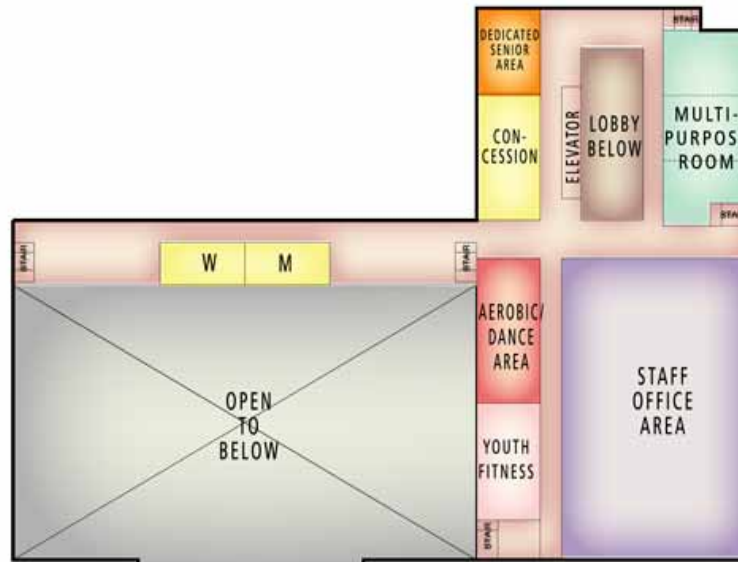

SECOND FLOOR

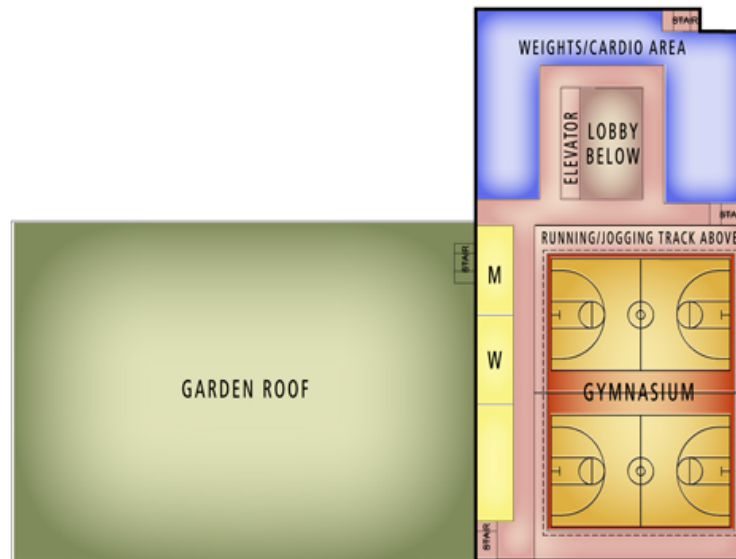

THIRD FLOOR