



OAK PARK CONSERVATORY

PARK DISTRICT OF OAK PARK



- Entrance**
- improve access as main entrance
 - emphasize as a main entrance to conservatory



- Outdoor Space**
- develop with paving surface, connect doorways;
 - develop space for educational programs, social events, exhibit gardens



- Existing Fence and Alley**
- remove and replace exist. fence;
 - relocate exist. fence to sidewalk;
 - potential closure of the alley.



- Service Area**
- reorganize/improve space for storage and materials;
 - provide space for employee use

I-290
Eisenhower Expy
NOISE

GARFIELD STREET

CLARENCE AVE.

S. EAST AVE.

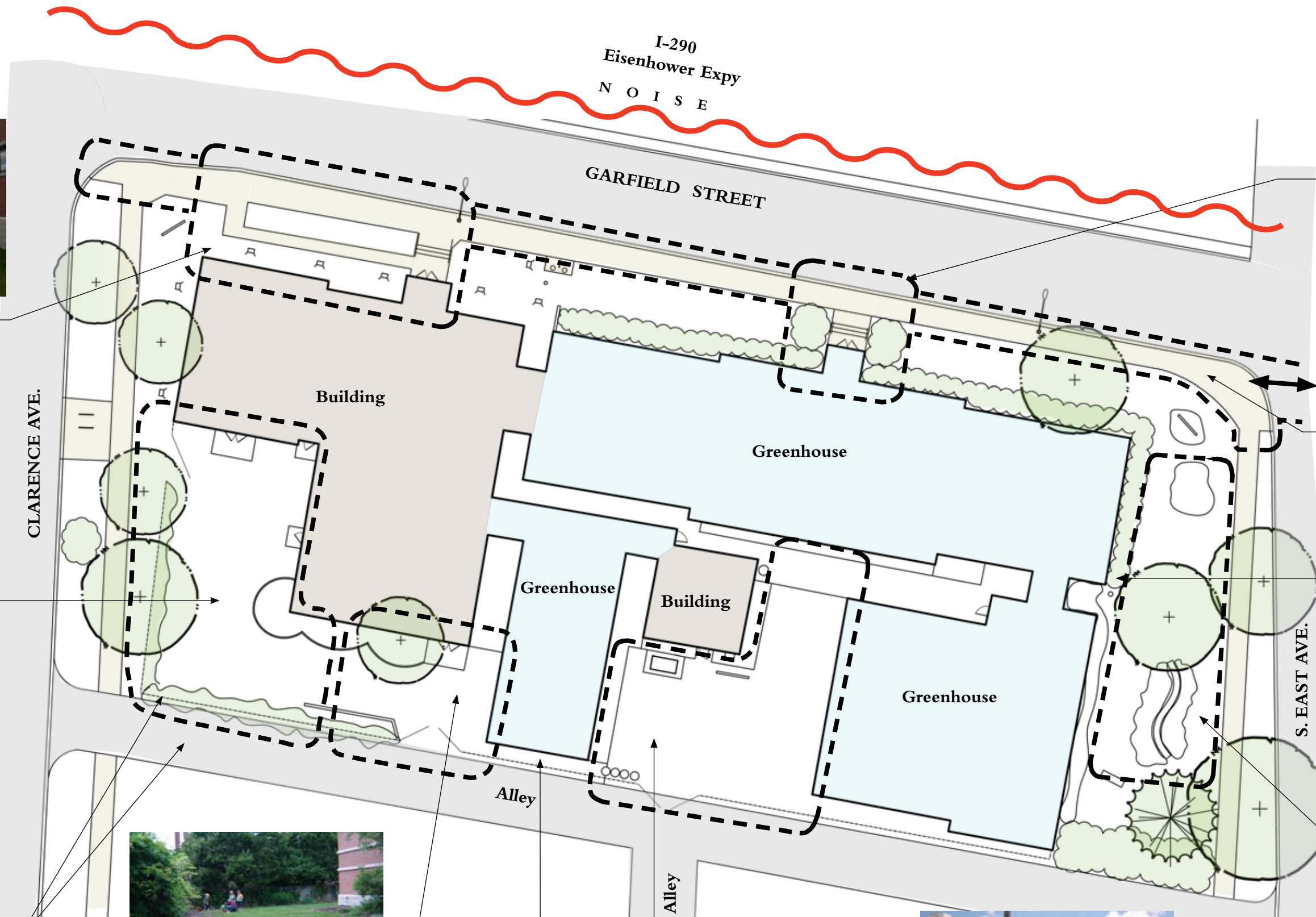

- Emergency Entrance**
- emphasize as emergency entrance;
 - maintain historic aspect



- Garfield Ave. Streetscape**
- provide visual connection between Conservatory and Rehm Park
 - potential streetscape improvements; paving, lighting, trees

- Building Foundation Landscape**
- remove existing landscape and replace with native plants



- Exhibit Garden Area**
- consider replanting area for special exhibit garden

- Maintenance/Storage Area**
- reorganize and improve space for storage and materials;

Provide access between Service Area and Storage Area



SITE DATA:

Total Site Area:	0.76 Ac
Bldg./ Greenhouse Area:	0.37 Ac (48%)
Service/ Storage Area:	0.10 Ac (13%)

